

# JLB-8,000t Hai Yang Shi You 221

## Jacket launch / transport barge



**Owner** China Offshore Oil Engineering Co. Ltd.  
**Builder** Dalian Shipbuilding Industry  
**Delivered** 2003

GustoMSC performed a complete fast track design and engineering contract (12 weeks) of a jacket launch-/transport barge in mid 2003 for COOEC.

Although the design of a launch barge might not be perceived as a highly complicated process, due to the client's design requirements, this particular barge shows some specific features. To meet existing local infrastructure, the barge is developed to perform load out operations at specific Chinese construction yards. To provide for easy load out and launch operations, the barge is equipped with a fully remotely controlled automated ballasting system.

### Main technical data

• Length over all	153.50 m
• Length between perpendiculars	142.00 m
• Breadth moulded	36.00 m
• Depth	9.75 m
• Design draught	7.60 m
• Maximum jacket weight for launching	8,000 ton
• Maximum transport capacity	21,000 ton
• Maximum load capacity m2	15.00 ton
• Installed power generation	2*550 kW
• Pump capacity	3*1,500 m <sup>3</sup> /hrs

### Environmental design conditions

#### Typical launch conditions

• Maximum wave height (Hs)	1.50 m
• Wave period (Tp)	8-9 sec
• Wind velocity (Vw)	10.7 m/s
• Current velocity (Vc)	0.9 m/s

#### Transport conditions

- Unrestricted ocean service

#### Scope of work

The design and engineering contract comprised of:

- Structural design of the barge
- Scantling drawings of hull
- Structural design of the skid- and rocker beams
- Structural and scantling drawings of skid- and rocker beams
- Ballast system (pumps, piping and control system)
- Time domain launch analysis
- Stability calculations
- Motion analysis
- Transport analysis
- Mooring and towing equipment

*Data presented in this product sheet is for information only. Unit specific specifications as provided by the Owner shall prevail.*

### The Netherlands

Karel Doormanweg 66, 3115 JD, Schiedam  
 P.O. Box 687, 3100 AR Schiedam

Telephone +31 (0)10 232 0800  
 Telefax +31 (0)10 232 0801

[www.GustoMSC.com](http://www.GustoMSC.com)



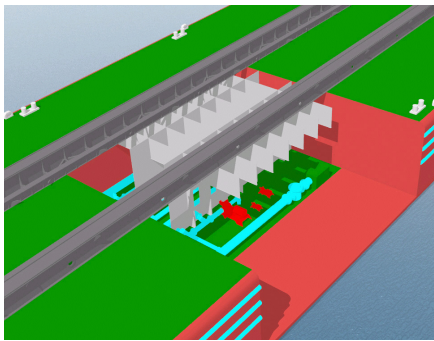

*Mid ship structure, pipe routing & pump room layout*

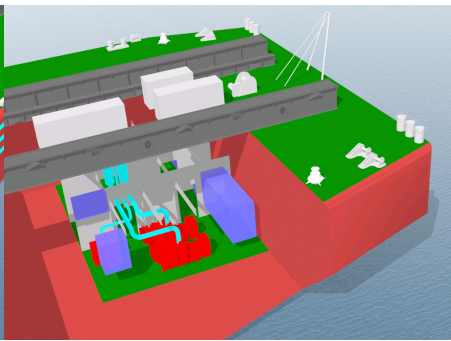

*Engine room layout*

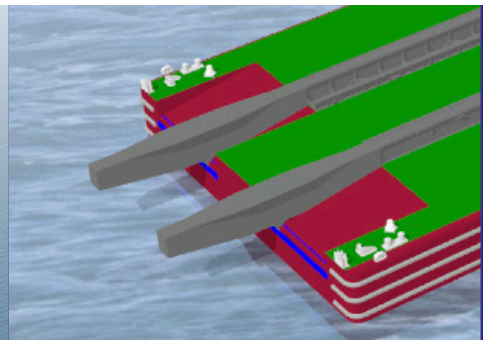

*Rocker- and skid beams*